



Please read through these instructions carefully prior to installation.



Scan or click to watch the video instructions

Parts Index

* not to scale



Patent Pending

- 1 Bend the tip of (F) Zip Tie to create a hook shape. Insert bent tip into vent until bent portion is seated all the way inside. Bent side will pop out through another portion of the vent grill.
For best stability, repeat using two of the three provided (F) Zip Ties.

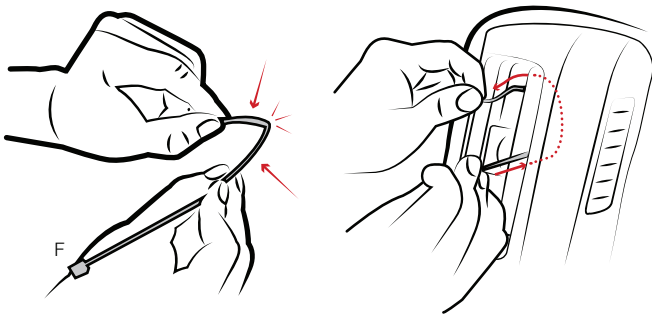

- 2 Apply (A) Vent Connector, routing (F) Zip Ties evenly through the center. Tighten zip ties to secure in place and trim excess.
Important: Vent Connector should not be loose, but do not over-tighten the zip ties as this could cause damage to the vent grill.

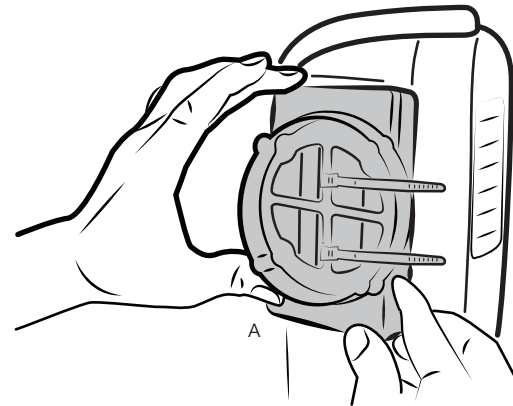

- 3 Twist and press ends of (D) Hose into (B) and (C) Hose Adapters

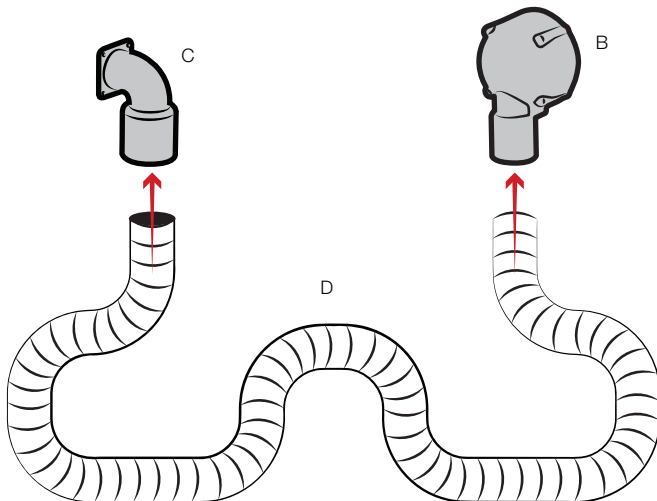

- 4 Connect (C) 90-Degree Hose Adapter to the back of your dock, and (E) Grill to the front of your dock, using the (G) Screws and (H) Nuts

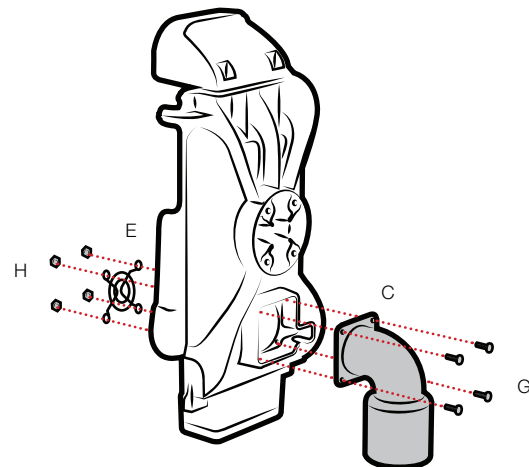

RMR-INS-VENT1



Safety Precaution

Refer to your car manual when installing any new products. RAM® Vent-Temp™ must be secured only to a RAM® or GDS® Vehicle Dock. Do not hold RAM® Vent-Temp™ while in use. Disconnect RAM® Vent-Temp™ Hose from your vent while the vehicle is not in use. Keep small parts and components away from children at all times. Never position hose near neck to avoid choking hazard. Do not leave children or pets in vehicle unattended. Do not install this product near or over an airbag deployment area or in a location that obstructs the driver's vision or interferes with vehicle operation. Failure to install properly may result in damage or injury. National Products, Inc does not assume responsibility or liability for any such personal injury, death or property damage.