

Item Number
RAM-VC-LEG-101

RAM Console Leg Kits

RAM Mounting Systems

Console Leg Kit for the FORD CROWN VIC/POLICE INTERCEPTOR (1991-2011)

SPECIFICATIONS

Drilling Requirements:
No drilling required

Finish:
Black Powder Coating

Placement:
Over transmission hump

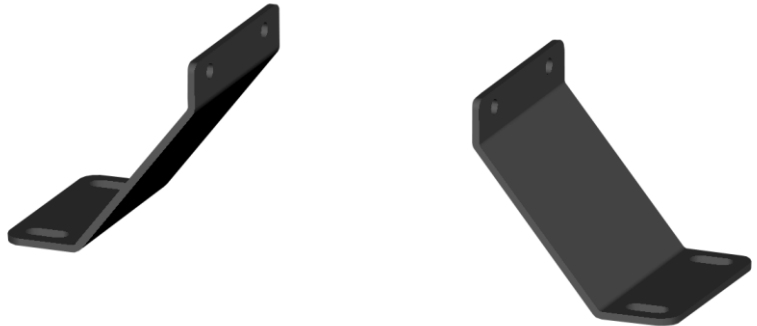

INSTALLATION INSTRUCTIONS

The purpose of this instruction sheet is to illustrate the manufacturer's recommended method of installation for the RAM-VC-LEG-101 Leg Kit that includes anchor legs and a bagged hardware kit.

1. Legs are attached to the base plate using two 3/8 x 3/4 inch bolts, flat washers, lock washers, and nuts per side. The base plate should be attached to the legs oriented with the stamped "R" toward the rear of the vehicle.
2. Remove all the bolts holding the seat frame legs to the vehicle floor.
3. Tilt the seats back slightly and position the RAM vehicle specific legs under the seat frame legs.
4. Align the holes in the legs with the holes or studs on the vehicle floor.
5. Lower the seats back into position and replace the hardware to secure the seat in place. The elevator bolt is attached and tightened against the floor using the hardware provided. If you find that the length of the supplied elevator bolt is inappropriate for your specific application, consider substituting a 1/4-20 carriage bolt of suitable length. These can be purchased at most any hardware store.



RAM-VC-LEG-101(Leg Kit)
shown attached to
RAM-VC-TP-29 (Top Plate)

Disclaimer regarding mounting of product:

National Products Inc. and/or RAM Mounting Systems is not liable under any theory of contract or tort law for any loss, damage, personal injury, incidental or consequential damages for personal injury or other damage of any nature arising directly or indirectly as a result of the improper installation or use of its products in vehicles or any other application. In order to safely install and use RAM Mounting System or National Products Inc. products full consideration of vehicle occupants, vehicle systems (i.e. the location of fuel lines, brakes lines, electrical, drive train or other systems), air-bags and other safety equipment is required. RAM Mounting Systems and National Products Inc. specifically disclaims any responsibility for the improper use or installation of its products not consistent with the original vehicle manufacturers specifications and recommendations. Never view or use a mounted electronic device while the vehicle is in motion. Always bring the vehicle to a complete stop prior to viewing or using a mounted device. Doing otherwise can endanger you, your passengers, or others outside your vehicle.

RAM Mounting Systems
8410 Dallas Ave S
Seattle, WA 98108
Phone: (206) 763-8361
Fax: (206) 763-9615
www.rammount.com
support@rammount.com



RMR-INS-VC-LEG-101

Area must be open or be made open to fit leg kits

SPECIFICATIONS

Drilling Requirements:

For some vehicles, drilling may be required.
See vehicle specific kits for No-Drill™ applications and universal for all others.

Finish:

Black Powder Coating

INSTALLATION REQUIREMENTS

The area between the front seats must be accessible in order to mount the leg kits and top plates to support a console.

The area must be open between bucket seats or, if the vehicle has a 40/20/40 front bench seat or similar configuration, the center section must be removed.

If the vehicle has a floor mounted shifter, either automatic, manual, or 4x4 lever, make sure there is ample room to the rear of the shifter and the floor board is clear before making a RAM-VC-LEG kit selection. The installed RAM-VC-LEG kit should be installed in a manner that does not interfere with the operation of shifters or levers.

For some vehicles, there may be room between the center of the bench seat front and the dash of the vehicle. If removing the center section of the bench seat is not an option, but there is room at this location, consider the universal leg kit, short top plate, and short console box as a possible solution.

If the vehicle is equipped with a factory installed center console, make sure it can be removed without :

1. Permanently disabling the vehicle.
2. Exposing sensitive electrical equipment to harm.
3. Exposing mechanical systems to harm.
4. Interfering with factory installed safety equipment.

Some factory installed equipment and consoles cannot be removed. If this is the case for your vehicle, consider other RAM products designed for mounting electronics safely and securely in your vehicle.

RAM Mounting Systems
8410 Dallas Ave S
Seattle, WA 98108
Phone: (206) 763-8361
Fax: (206) 763-9615
www.rammount.com
support@rammount.com



RMR-INS-VC-LEG-101