

Parts Index

* not to scale

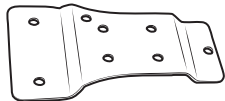

A (1) Mounting Plate



B (1) #8-32 x 3/8" Screw



C (4) #8-32 x 5/8" Screws



D (1) #8-32 x 1" Screw



E (2) #8-32 x 1 1/4" Screws



F (3) #8-32 x 1 1/2" Screws

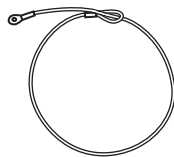

G (1) Lanyard



H (1) Zip Tie

For Granit Ultra 2105i

- 1 Connect Granit Ultra 2105i dock to **(A) Mounting Plate** using 3 **(F) 1 1/2" Screws**.

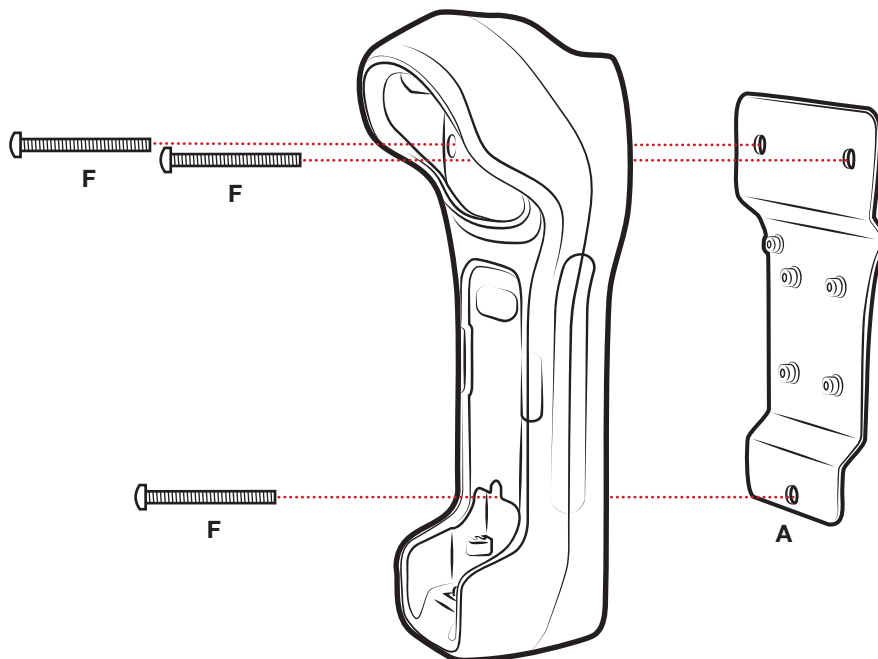

For Granit XP1991i

- 1 Connect Granit XP1991i dock to **(A) Mounting Plate** using 2 **(E) 1 1/4" Screws** and 1 **(D) 1" Screw**.

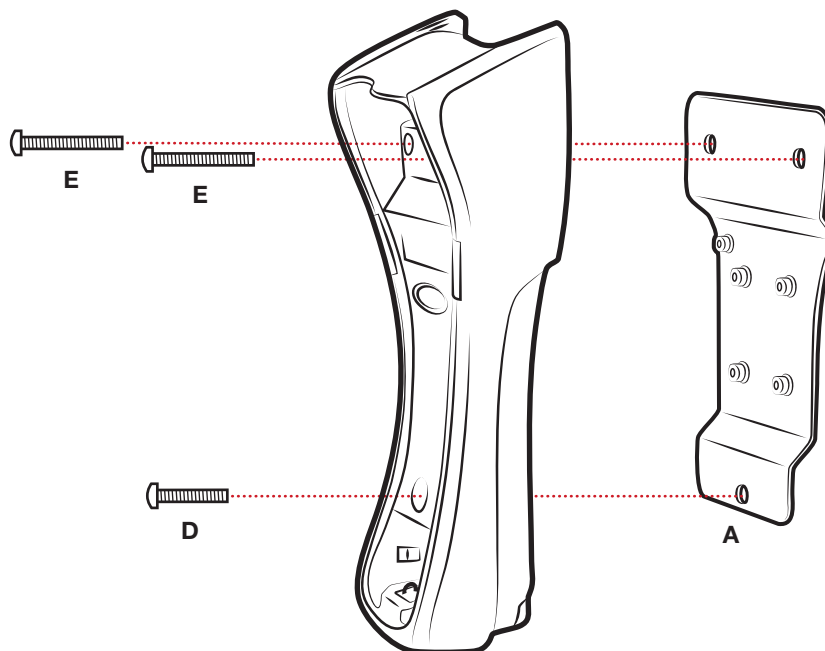

Ball Attachment

- 2 Connect **(A) Mounting Plate** to RAM® Ball Adapter (not included) using 4 **(C) Screws**.

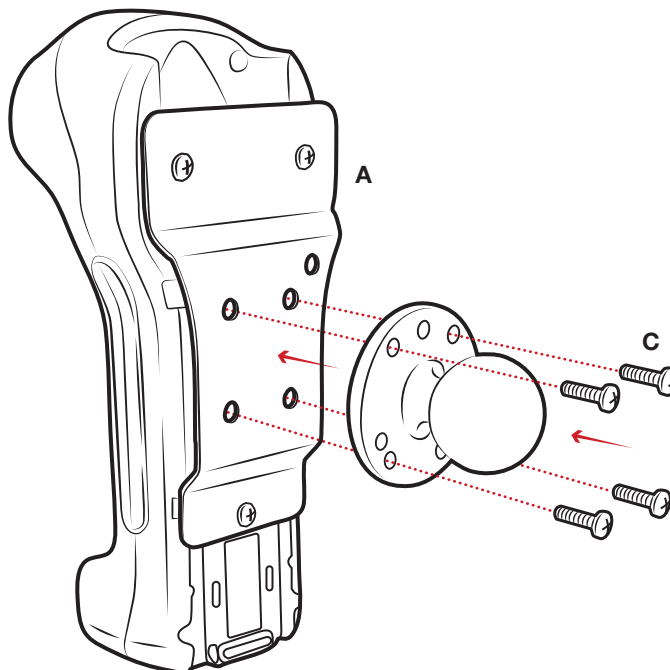

Lanyard Attachment (Optional)

- 3 Route **(G) Lanyard** through bottom of scanner.
- 4 Insert end of **(G) Lanyard** through the loop of the opposite end.
- 5 Connect hole of **(G) Lanyard** to extra hole of **(A) Mounting Plate** using **(B) Screw**.

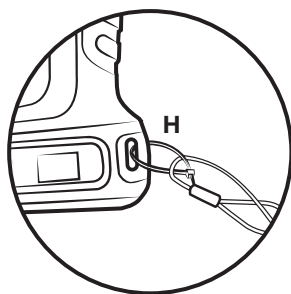

Can also connect **(G) Lanyard** to scanner with **(H) Zip Tie**

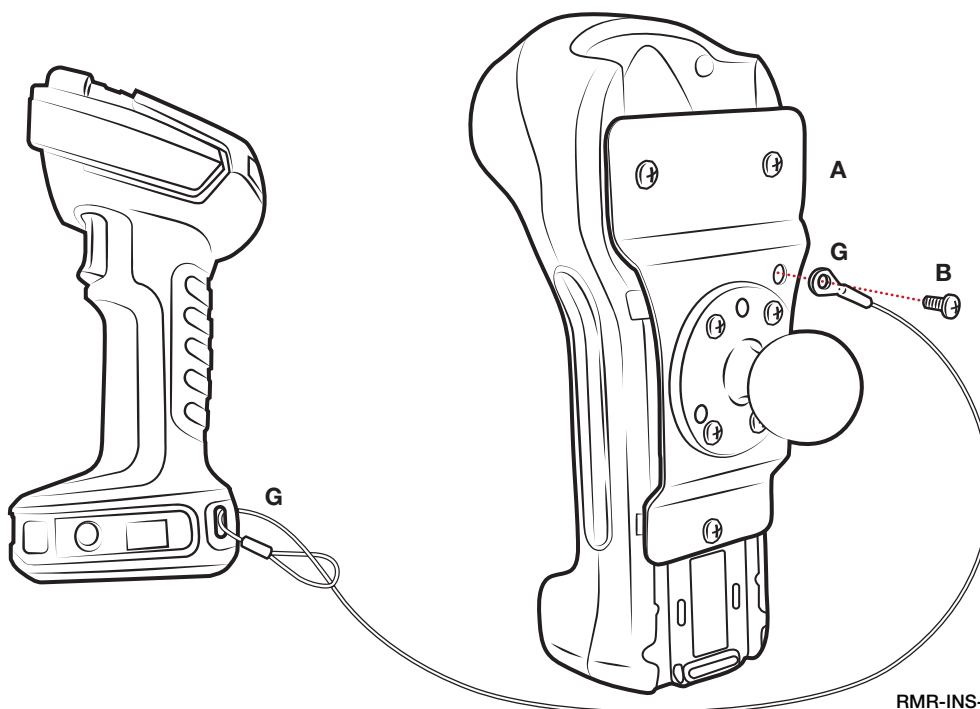

RMR-INS-HON15