

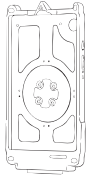







Parts Index

* not to scale

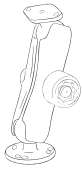
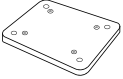
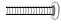
- A** IntelliSkin® with Uni-Conn™ Adapter 
- B** Uni-Conn™ Dock 
- C** Dock Mounting Hardware Pack
 - (x2) #8-32 x 1" Screws 
 - (x2) #8-32 Nylock Nuts 
 - (x1) Locking Lever Stop 
- D** Locking Double Ball Mount 
- E** Backing Plate 
- F** Backing Plate Hardware
 - (x4) #8-32 x 1" Screws 
 - (x4) #8 Lock Washers 
 - (x4) #8 Washers 
- G** Hardwire Charger 
- H** USB-C Cable Clamp Kit 

Patented & Pats. Pend.
rammount.com/ip

- 1** Assemble **(D) Locking Double Ball Mount** with **(B) Uni-Conn™ Dock** using the **(C) Dock Mounting Hardware Pack**.

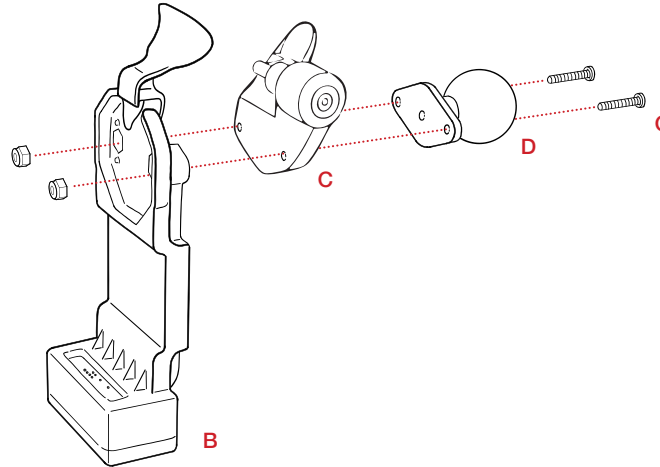

Completed Step 1 Assembly View

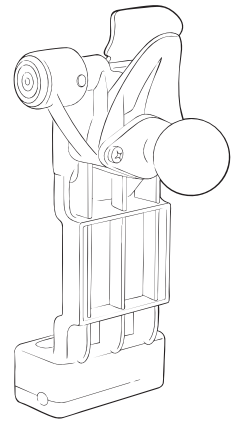

- 2** Connect **(D) Locking Double Ball Mount** to **(E) Backing Plate** using **(F) Backing Plate Hardware Pack**.

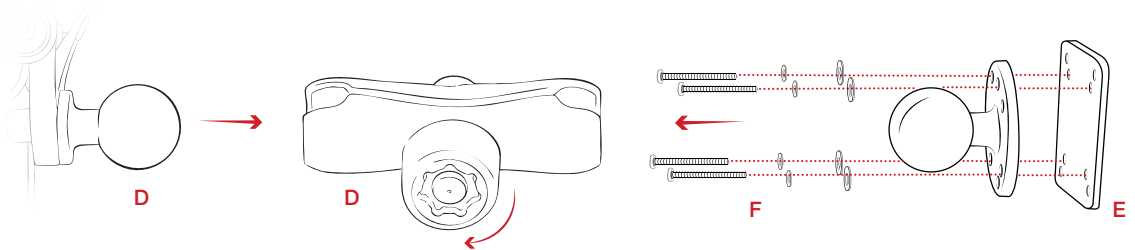

Wiring and Retention Diagram

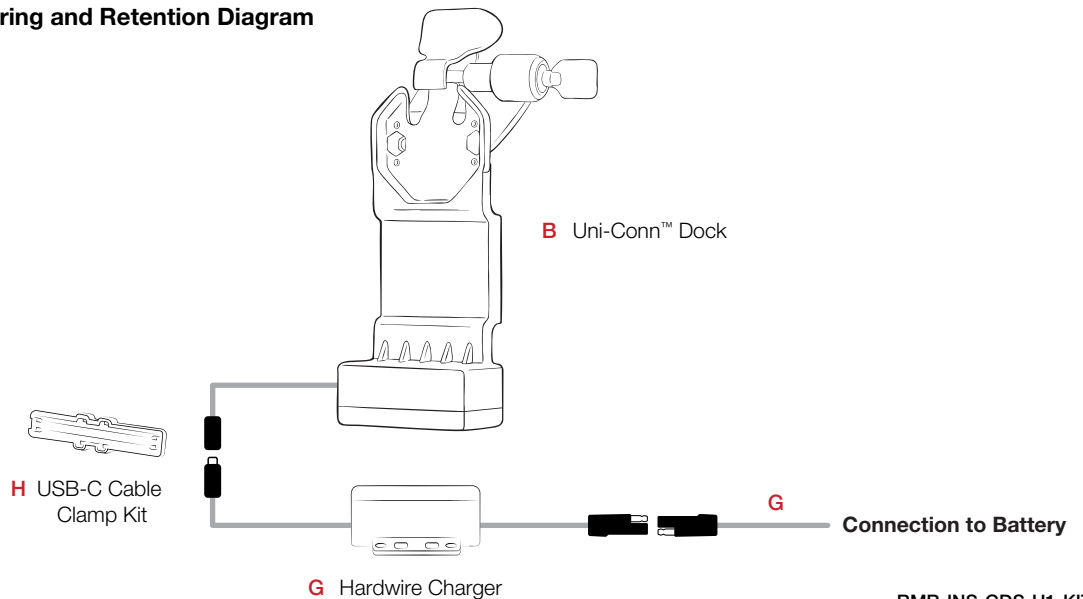

RMR-INS-GDS-U1-KIT2



Safety Precaution

Do not install this product near or over an airbag deployment area or in a location that obstructs the driver's vision or interferes with vehicle operation. National Products, Inc does not assume responsibility or liability for any such personal injury, death or property damage.