



rammount.com
1.800.497.7479
support@rammount.com

Converting Cigarette Lighter Adapter to Bare Wire Leads

Assembly Instructions

- 1 Remove cigarette lighter portion of external power supply using wire cutters.
- 2 Strip insulation to desired length.
- 3 Strip positive lead to desired length.

Please ensure that the in-line power conversion box is adequately secured to prevent movement about the cab of the vehicle or similar installation environment. Be mindful to ensure it is located out of common ingress/egress areas as to avoid tangling with the end user. Please use all cable retention features supplied with this product, and use best practices in wire routing to avoid damage to the mount or mounted device. Not following these instructions may void your warranty.

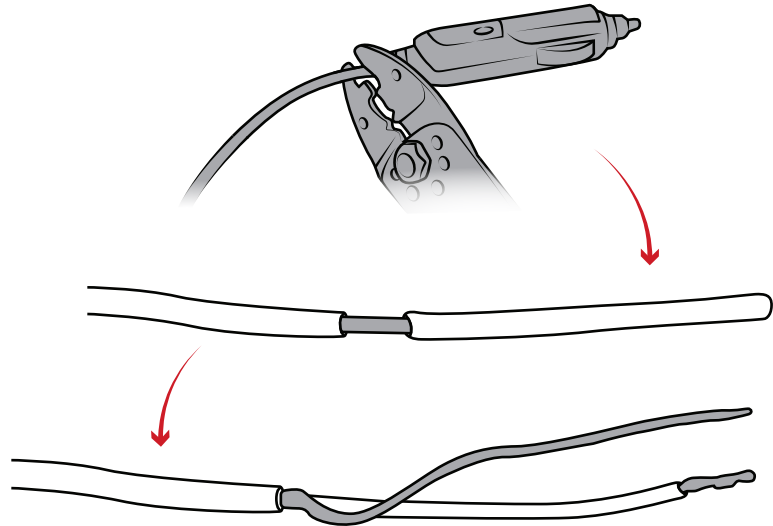

RMR-INS-EXTR