

Parts Index

* Not to scale

Patented & Pats. Pend.
rammount.com/ip

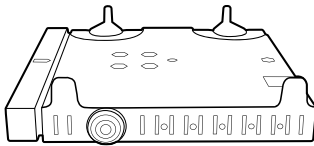

A

Tray Assembly



B

(x4) Long Arms



C

(x4) Short Arms



D

(x4) Angled Brackets

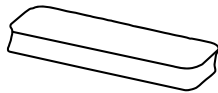

E

(x2) Foam Pads

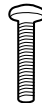

F

(x2) Screws
#8-32 x 3/4"



G

(x2) Nylock Nuts
#8-32

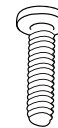

H

(x4) Screws
#10-24 x 3/4"



I

(x6) Nylock Nuts
#10-24

1 Place laptop on tray with lid open. Using a screwdriver, loosen and rotate the rear posts to seat properly against the back of your laptop.

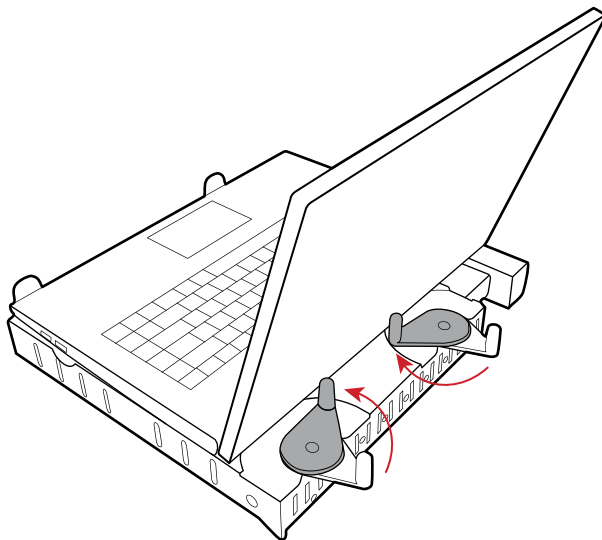

2 Select **(B)** or **(C) Arms** depending on what is most appropriate for the thickness of your laptop. Slide **(D) Angled brackets** into selected arms until you hear a satisfying "click".

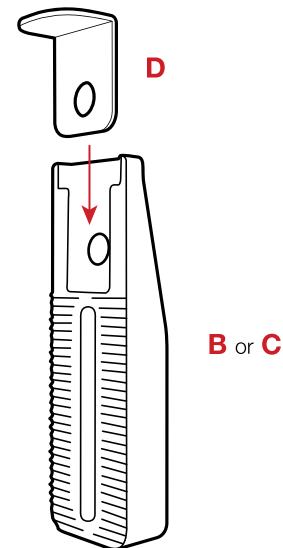

RMR-INS-2347



Safety Precaution

Do not install this product near or over an airbag deployment area or in a location that obstructs the driver's vision or interferes with vehicle operation. Electronic devices attached to this product are not to be used while vehicle is in motion. National Products, Inc. does not assume responsibility or liability for any such personal injury, death, or property damage.

- 3** Connect selected arms from Step 2 to the sides of the **(A) Tray** using **(F) Screws** and **(G) Nuts**. Select holes on the sides of the tray that will not block any necessary port or drive access.

Position the arms so that the **(D) Angled Brackets** rest flush against laptop keyboard.

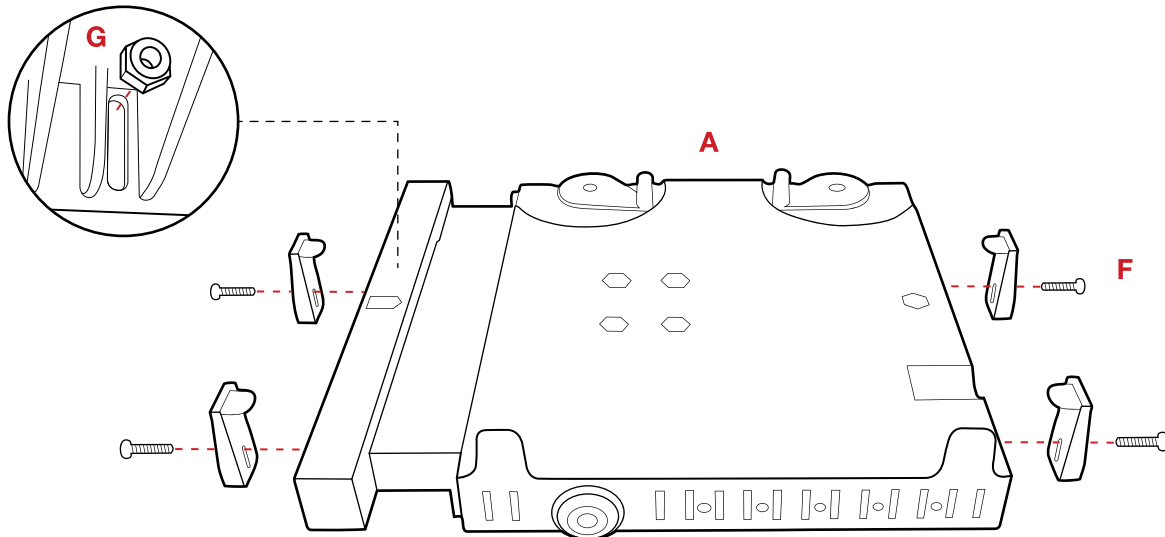

- 4** Connect **(A) Tray** to ball (not included) using **(H) Screws** and **(I) Nuts**.

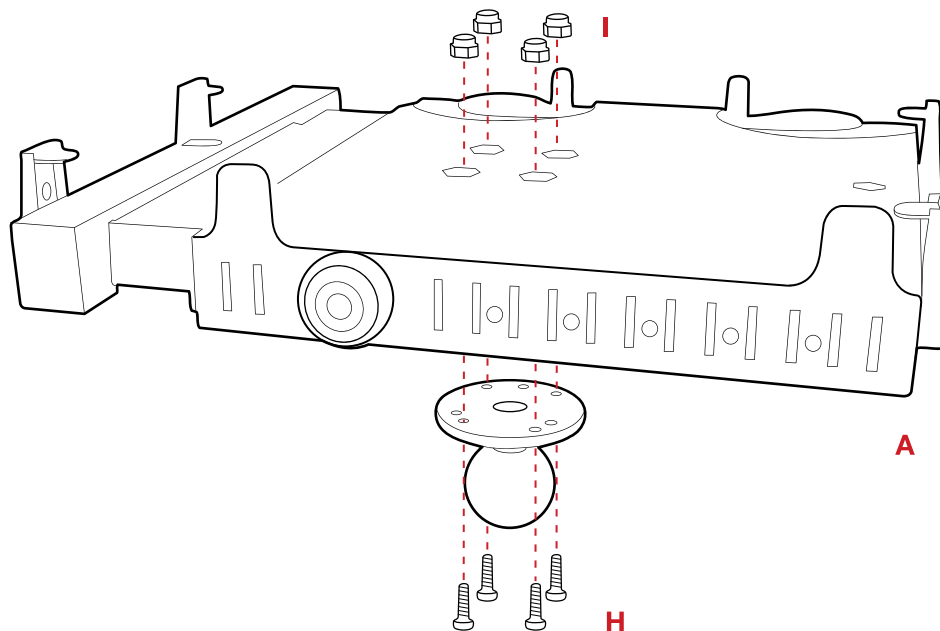

RMR-INS-2347



Safety Precaution

Do not install this product near or over an airbag deployment area or in a location that obstructs the driver's vision or interferes with vehicle operation. Electronic devices attached to this product are not to be used while vehicle is in motion. National Products, Inc. does not assume responsibility or liability for any such personal injury, death, or property damage.