

## Parts Index

not to scale

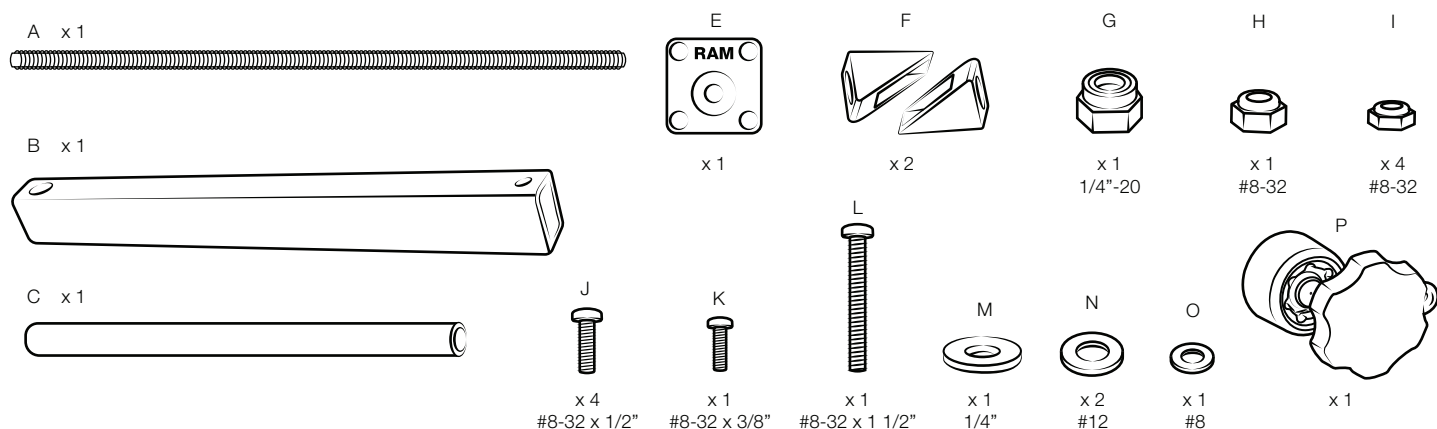

- 1 Thread (G) nut onto (A) rod with 3/8" of the rod protruding.
- 2 Slide (F), (N) and (C) onto rod as shown below.

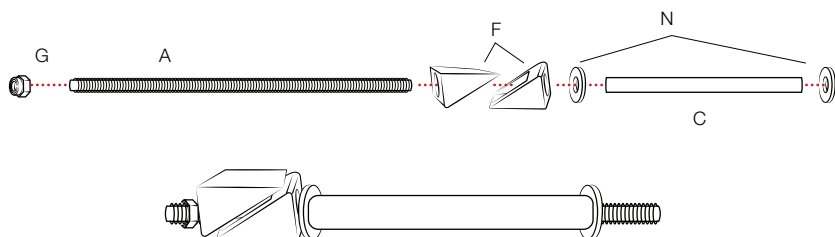
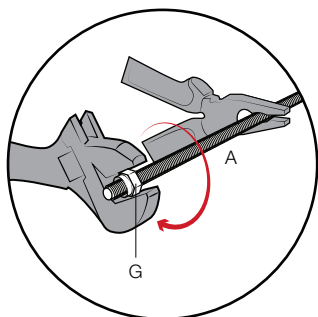

- 3 Pull the Main Tray Slide out and attach (E) flange using (J) screws and (I) nuts. RAM® logo must face upright.
- 4 Locate and remove screw on the tray housing supporting the spring.

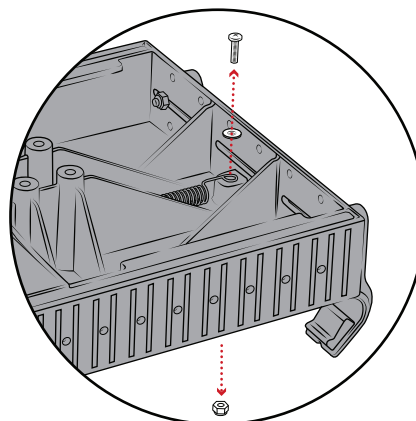
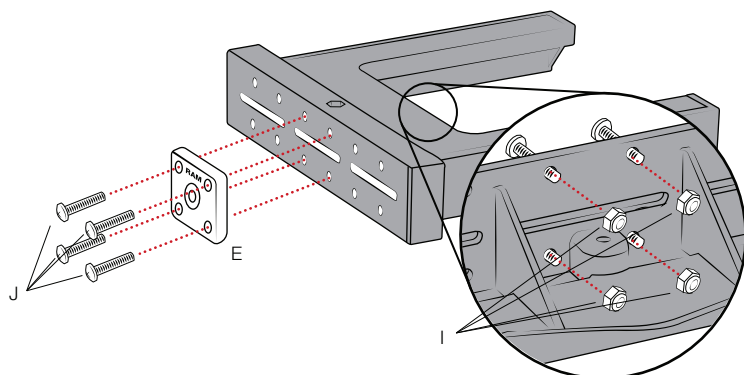

Continue on back →



### Safety Precaution

Do not install this product near or over an airbag deployment area or in a location that obstructs the driver's vision or interferes with vehicle operation. National Products, Inc does not assume responsibility or liability for any such personal injury, death or property damage.

- 5 Insert (L) screw in the opposite direction, align the Tray Slide back into Tray Housing and pull the end of the spring over screw.

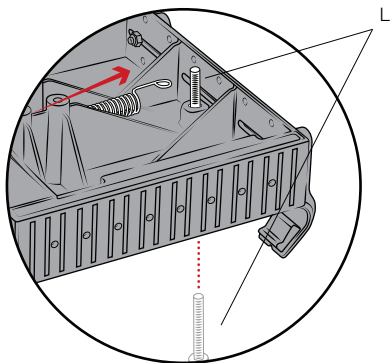

- 6 Use the washer that comes with the original tray and place over (L) screw. Feed (B) tube with larger hole first through Main Tray Housing and slide over (L) screw. Gently secure with nut (H).

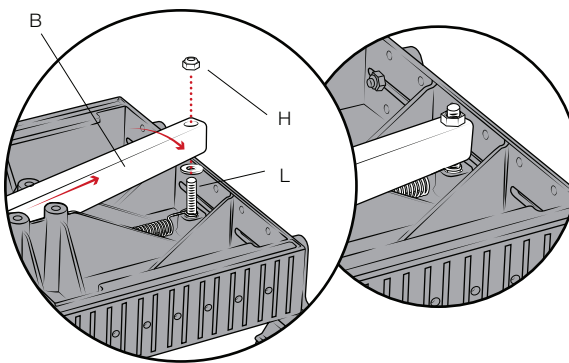

- 7 Pull Tray Slide out and wedge as shown.

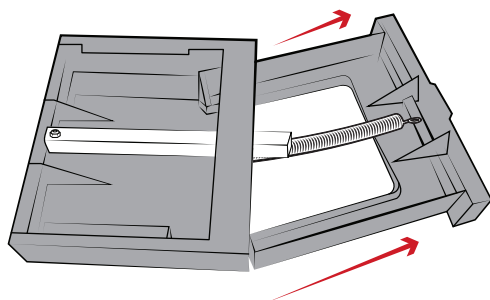

- 8 Fully insert Threaded Rod Assembly from Step 2 into (B) tube. Separate (F) wedges as needed.

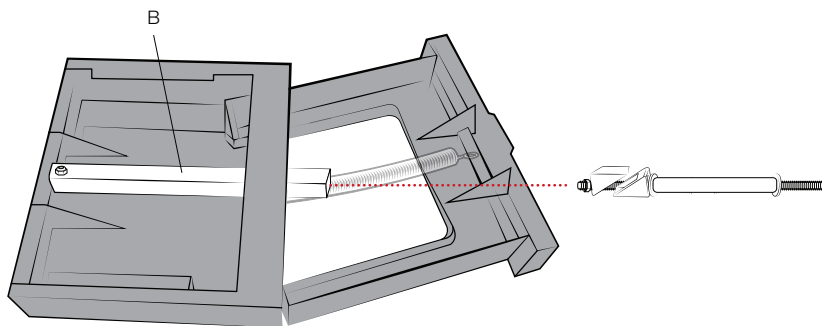

- 9 Close Main Tray Slide slowly while feeding the end of Rod Assembly through (E) flange. Place (M) washer on the end and attach (P) RAM® Pin-Lock Nob all the way. Secure the Rod Assembly with (O) washer and (K) screw through the smaller hole on the (B) tube.

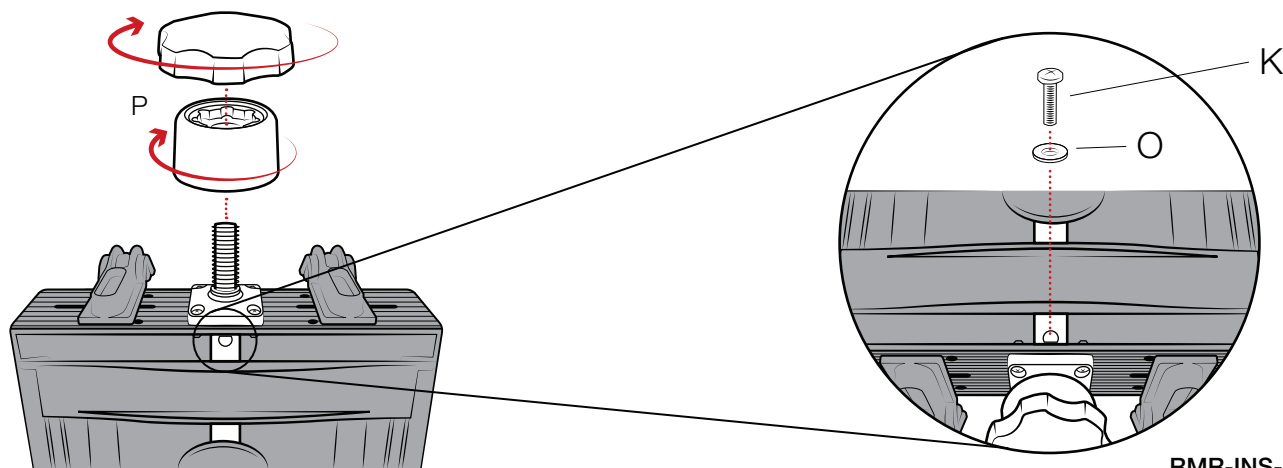

RMR-INS-234-LK



## Safety Precaution

Do not install this product near or over an airbag deployment area or in a location that obstructs the driver's vision or interferes with vehicle operation. National Products, Inc does not assume responsibility or liability for any such personal injury, death or property damage.